

The Tess 421 system is a wire guided tension blind suitable for external use on horizontal and sloping glazing. It is specifically designed for right-angled triangular areas. It has a single fabric roller incorporating the motor and tension mechanism and one continuous tension cable for ease of fitting.



Technical specification

Model	T11460	
Maximum width	(m)	4
Maximum draw	(m)	5
Maximum fabric area (square)	(m ²)	9
Basic weight (1 metre wide system)	(kg)	15 (max)
Additional weight per metre width	(kg)	5 (max)
Typical fixing load	(kg)	24
Maximum fixing load	(kg)	36
Motor torque	(Nm)	15
Motor speed	(min ⁻¹)	17
Motor current at 230VAC	(A)	0.6
Motor cable length	(m)	2.5
Temperature range	(°C)	-5 to +55
Maximum run time	(min)	4
Minimum fabric speed	(m/min)	5

Description:

- an **85mm galvanized steel fabric roller tube** incorporating **motor and spring tension compensation cassette** to maintain **constant tension** throughout the travel.
- 5m capacity cable drum to take up the continuous nylon-coated **stainless steel tension cable**.
- a gear-operated mechanical tension adjustment within the drum to enable the **fabric tension to be adjusted between 5 and 25kg**.
- an **extruded aluminium head-box**.
- all visible aluminium parts syntha pulvin **polyester powder-coated** in the system colour specified.



Assessed to ISO 9001: 2000
Certificate No 193

Guthrie Douglas

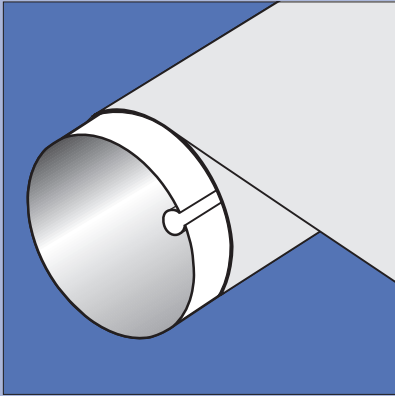

Fabric Roller

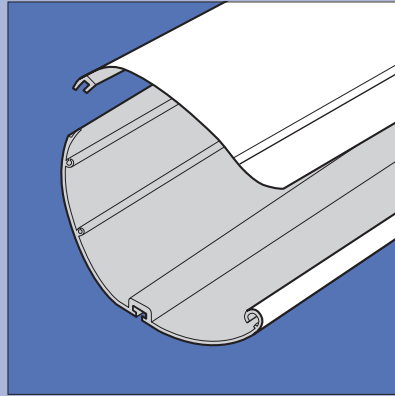

Section through hood

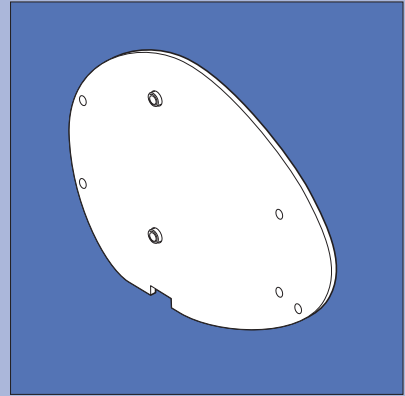

Cheek plate

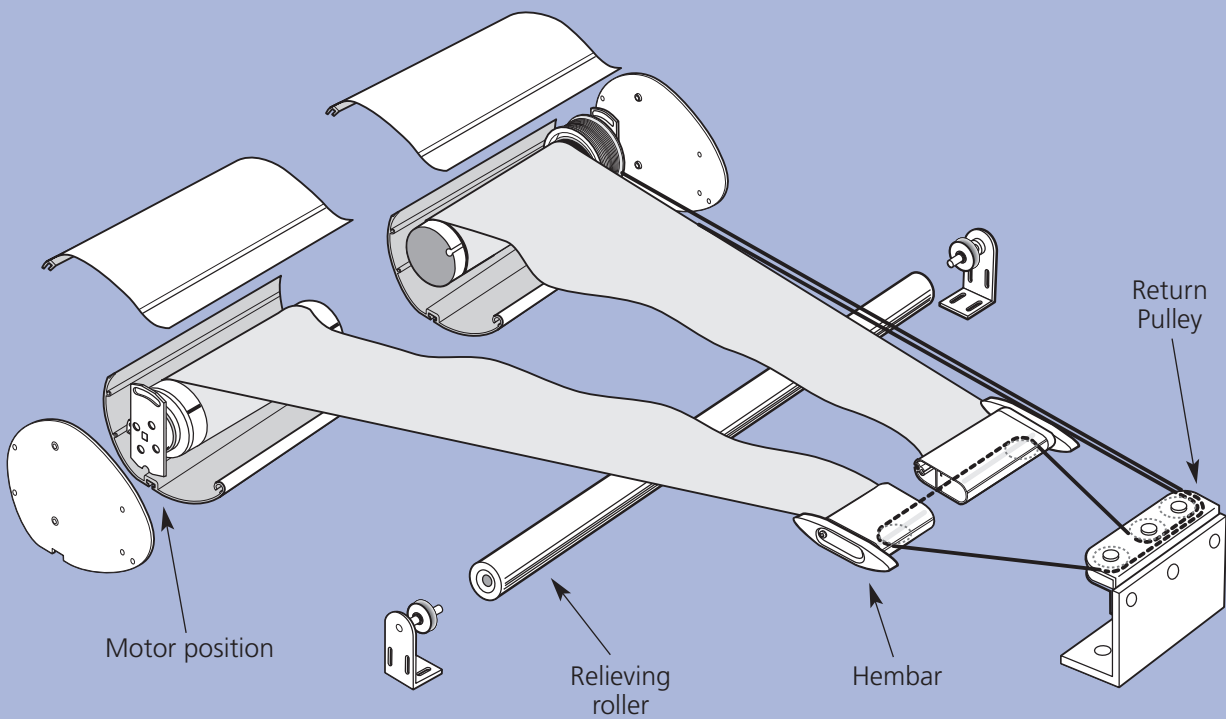

Motor position

Relieving roller

Hembar

Return Pulley

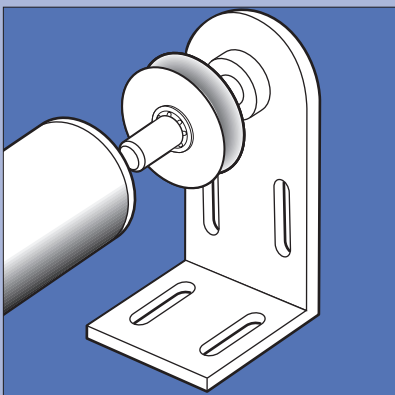

Relieving roller bracket

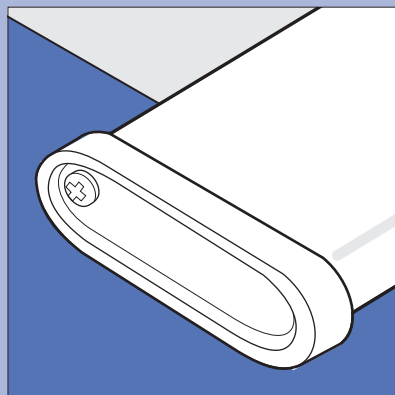

Alternative hem bar end cap for system without relieving roller

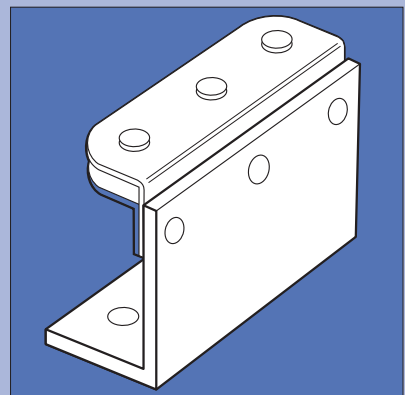

Return pulley assembly

System Dimensions

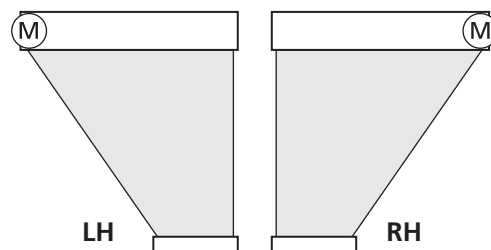
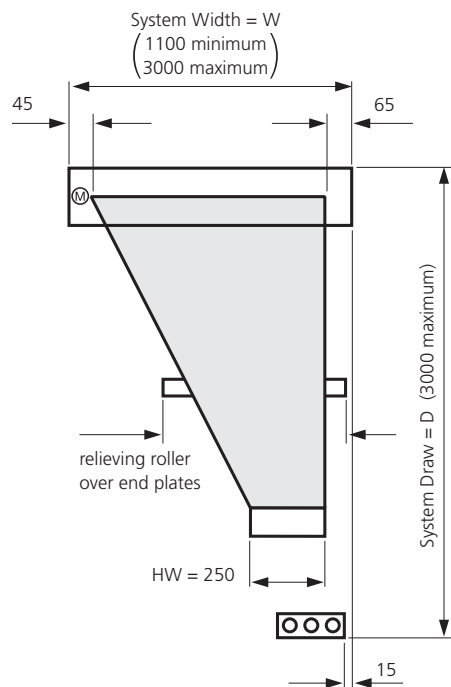

Can be supplied with
LH or RH motor

Fabric Shape

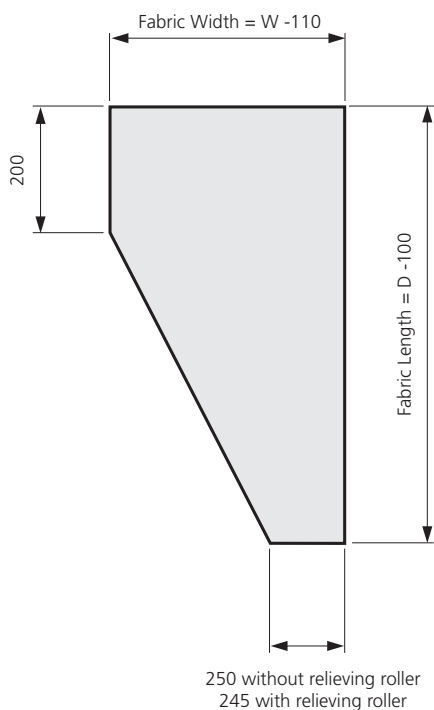

Maximum fabric
weight 450g/m²

Note: according to the size and shape,
fabric battens may be required to support
the diagonal edge.

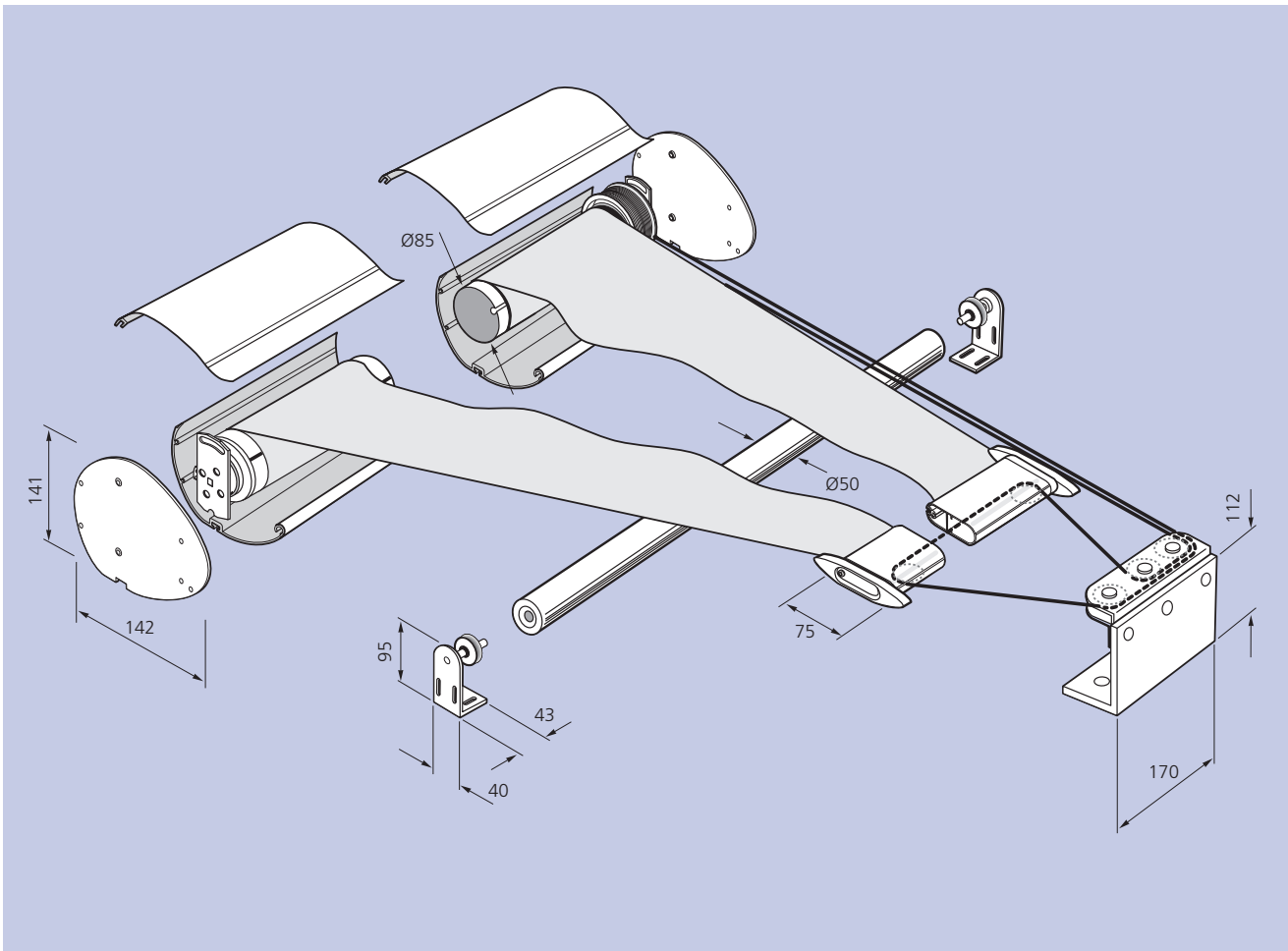

Guthrie Douglas

Guthrie Douglas Limited

12 Heathcote Way, Heathcote Industrial Estate
Warwick, UK CV34 6TE

Telephone: (+44) 01926 452 452 Fax: (+44) 01926 832 914

E-mail: sales@guthriedouglas.com Web site: www.gdsolarcontrol.com