



Springs Window Fashions LP

# Window Treatment Horizontal Blinds

## Graber Lake Forest™ 2" Faux Wood Blinds



### PART 1—GENERAL

#### 1.01 DESCRIPTION

##### A. Related Requirements

1. The Conditions of the Contract (General and Supplementary, and other Conditions), and Division 1-General Requirements (if any) are part of this section. (Delete or retain as appropriate.)

#### 1.02 QUALITY ASSURANCE

##### A. Job Mock-Up: (Describe)

#### 1.03 SUBMITTALS

- Manufacturer's Product Data:** Submit manufacturer's descriptive product data and installation instructions for each type of blind specified.
- Shop Drawings:** Submit shop drawings indicating the following:
  1. Field-measured dimensions of openings scheduled to receive blinds.
  2. Illustrations of special accessory components not included in manufacturer's product data.
  3. Details of head and sill conditions, corner conditions, and conditions between adjacent blind units.
- Color Sample:** Submit two 6" (0.15m) samples of material indicating full color range and color variation.
- Product Sample:** Submit one 16" wide by 24" long fully functional sample blind.
- Maintenance Material (Extra Stock):** (Describe)

### PART 2—PRODUCTS

#### 2.01 2-INCH HORIZONTAL BLINDS

##### A. Manufacturer and Product:

1. **Manufacturer:** Springs Window Fashions LP
  - a. **Product:** Graber Lake Forest 2" Horizontal Blind.
  - b. **Options:** (Describe)
  - c. **Color(s):** Selected from Graber color standards.

##### B. Product Description:

1. **SureClose™ Headrail:** "U"-shaped 1½" high by 2¼" deep channel with a ⅛" light blocking lip on the bottom center line fabricated from 0.022" thick phosphate treated steel with rolled edges at top with a prime coat of vinyl primer and finished coat of polyester baked enamel to match bottomrail and end support brackets and to coordinate with slats. Headrail shall be roll-formed.
2. **Head Channel Hardware:** Metal hardware shall be electroplated with lift cords and ladders guided by acetal low friction thermoplastic grommets in the head channel that prevents wear and discoloration. Operating hardware shall be mechanically locked into head channel, by means of snap-in fittings with no mechanical cleats visible from underside of headrail.
3. **Extruded Foam PVC Bottomrail:** Foam PVC bottomrail ⅝" high by 2" wide. Bottomrail color shall coordinate with slats.
4. **Slats:** Rigid, UV stabilized flat PVC, nominally 2" wide and .10" thick. Slat edges are straight cut.
5. **Tilt Rod Support:** Tilt rod support shall be low friction thermoplastic and shall support tilt rod. It shall provide a smooth bearing and center the ladder drum over ladder hole. Incorporated with tilt rod support shall be metal lift cord rollers to guide lift cords when entering and exiting headrail for smoother lifting and lowering operation. Grommet shall prevent cord and braided ladder wear and discoloration.
6. **Ladder Drum:** Ladder drums are made of high strength thermoplastic which securely attaches braided ladder. Cloth tapes are not available on Lake Forest.
7. **Cord Lock:** Metal cord lock shall be of a snap-in design and incorporate a floating shaft-type locking pin. The freely rotating locking pin shall offer minimum wear to cord. Cord lock shall incorporate a crash-proof safety

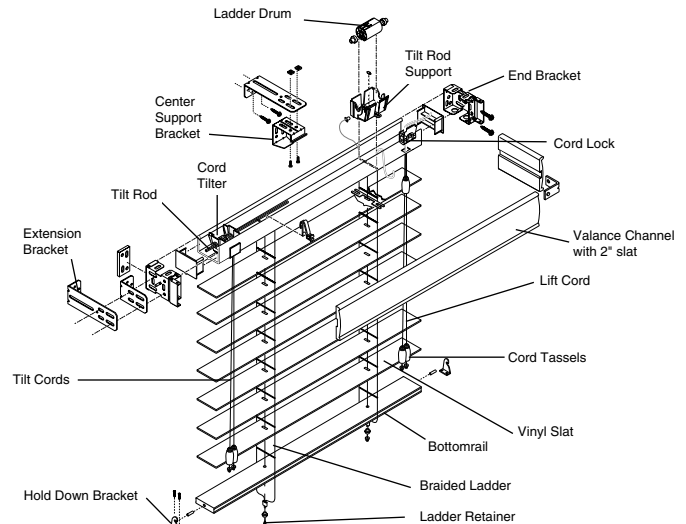

Lake Forest 2" Horizontal Blind

feature that shall lock blind automatically upon release of cord. End of lift cords shall be treated with plastic tassels.

8. **Cord Tilter:** Snap-in component incorporating a worm and pulley of low friction thermoplastic and a gear of nylon. Tilt cords shall be secured to pulley and treated with tassels at tilt end.
9. **Square Tilt Rod:** Tilt rod shall be electro-zinc coated solid steel. Tilt rod shall be hexagonal in cross-section measuring ¼ inch at its widest points.
10. **Braided Ladders (Slat Supports):** Braided ladder which will assure proper control with adequate overlap of slats in the closed position. Distance between end ladder and end of slats will not exceed 4"; distance between braided ladders shall not exceed 11".
  - a. **Braided Ladder Material:** Material shall be 100% high tenacity polyester yarn. Vertical component shall be not less than 0.060" diameter nor greater than 0.080" diameter, which will provide maximum strength and flexibility with minimum stretch. Horizontal component, or rungs, shall be not less than two threads and shall be approximately 53.0mm long. Ladder will provide 44mm of distance between slats. Ladders shall be of a sufficient length for bottom of blind to hang with a tolerance of plus one-half/minus zero inches of the specified length. Ladders shall be dyed to Graber color standard.
  - b. **Braided Ladder Clip:** Plated metal clip shall be mechanically clinched to the end of each braided ladder to lock in holes of ladder drum.
11. **Lift Cord:** Lift cord shall be braided with polyester jacket and center core or an approved equal construction. Size of cord shall be 1.8mm. Cords shall be detachable, if required, and shall be of sufficient length to properly control the raising or lowering of the blind. Lift cords shall be equipped with plastic tassels. Cord ends shall be securely anchored to the bottomrail and it shall be possible to detach and attach cords. Cording arrangements shall comply with assembly standards set for the size and weight of the blind. Cords shall be coordinated to Graber color standard.
12. **Cord Lock and Tilter Operation Locations:**
  - a. Graber 2" Horizontal Blinds shall be made with the following cord lock and tilter location options when viewed from within the room:
    - 1) Tilter at left, cord lock at right (standard).
    - 2) Cord lock at left, tilter at right (reverse).
13. **End Support Brackets:** Universal hinged cover end support brackets of phosphate treated steel with a prime coat of vinyl primer and a finish coat of baked on polyester enamel in color to match headrail. Brackets shall facilitate

# Window Treatment Horizontal Blinds

## Graber Lake Forest™ 2" Faux Wood Blinds

easy removal of head channel and will include an adjustable tab to eliminate lateral headrail movement.

14. **Intermediate Support Brackets:** Brackets shall be of electroplated steel stamping, and shall be furnished for blinds over 48" wide.
15. **Extension Brackets:** Optional adjustable extension brackets are available. Brackets allow extensions of 1" and 1½".
16. **Hold-Down Brackets:** Universal hold-down brackets for sill or jamb installations are available.
17. **End Stiffeners:**
  - a. To add rigidity to the headrail, thermoplastic end stiffener caps shall be inserted at each end of the headrail.
18. **General:** The blind shall be free of sharp edges, burrs or other defects which might be harmful. When other materials result in improved specifications, they may be adopted.
19. **Maximum width and drop varies based on blind dimensions:**

Blind Width Range	Max. Drop Single Blind	Max. Drop 2 or 3 blinds on 1 Headrail
12-30"	120"	N/A
30½-36"	108"	120"
36½-42"	90"	120"
42½-48"	78"	120"
48½-54"	72"	120"
54½-60"	60"	120"
60½-66"	54"	108"
66½-72"	54"	102"
72½-78"	N/A	96"
78½-84"	N/A	84"
84½-90"	N/A	78"
90½-96"	N/A	72"

  - b. Narrow width blinds between 9" and 11½" have a maximum drop of 84 inches and are tilt control only.
20. **Color:** Color of headrail, ladder and cord shall coordinate with slats. Bottomrail will be white and plastic headrail components will be either white or black.

### 2.02 FABRICATION

- A. Prior to fabrication, verify actual opening dimensions by on-site measurements. Calculate blind dimensions to fit within specified tolerances.
- B. Fabricate blinds to fill openings from head to sill and jamb to jamb. Locate blind divisions at mullions.
- C. Fabricate blinds to fill all exterior window openings except at doors, door sidelights and transoms unless noted.

### PART 3—EXECUTION

**3.01 INSPECTION:** Verify that the work area in which the blinds will be installed is free of conditions that interfere with blind installations and operations. Begin blind installation only when unsatisfactory conditions have been corrected.

### 3.02 INSTALLATION

- A. Install blinds in accordance with manufacturer's procedures except as otherwise specified herein.
- B. Install intermediate support brackets and extension brackets as needed to prevent deflection in headrail.
- C. Install blinds with adequate clearance to permit smooth operation of blinds and any sash operators.
- D. Set tilt and lift controls. Demonstrate blinds to be in smooth, uniform working order.

### 3.03 CLEANING

- A. Clean soiled blind surfaces with a mild soap solution. Do not use steam, hot water, bleach or any abrasive or solvent-based cleaners.
- B. To ensure proper drying, provide adequate ventilation for blinds, remove bottomrail plastic end caps, and tip headrail and bottomrail to drain water.

### 3.04 HORIZONTAL MINI BLIND SCHEDULE:

Provide blinds at the following locations: (listing of blind locations, different options, types, accessories and colors).

